

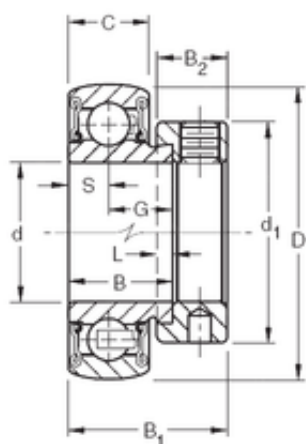

## BEARING Driveshaft do Brasil



31.75 mm x 72 mm x 25,4 mm AH24028  
Withdrawal Sleeves 135x140x83mm

Bearing No. RA104RRB

Size	31.75x72x25.4 mm
Bore Diameter	31.75 mm
Outer Diameter	72 mm
Width	25,4 mm
d	31.75 mm
D	72 mm
B	25,4 mm
C	19 mm
d1	54,4 mm
B1	38,9 mm
B2	17,1 mm
G	15,9 mm
L	4 mm
S	9,5 mm
Weight	0,562 Kg
Basic dynamic load rating (C)	28,5 kN

RA104RRB Bearing 2D drawings and 3D CAD models