

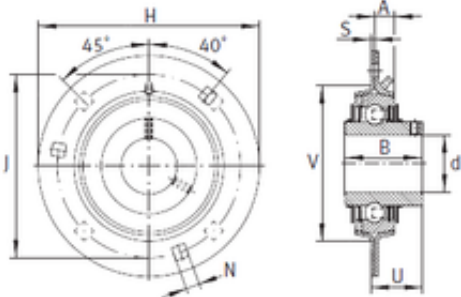

BEARING Driveshaft do Brasil

CAT320B Excavator CATERPILLAR Double Row Slewing Bearing 1308*1082*100mm



Bearing No. GRRY20-VA

GRRY20-VA Bearing 2D drawings and 3D CAD models

Bore Diameter	20 mm
d	20 mm
V	55 mm
U	20,3 mm
A	8 mm
B	31 mm
H	90,5 mm
J	71,5 mm
N	8,7 mm
S	2 mm
Category	Flange Block Bearings
Inventory	0.0
Manufacturer Name	SCHAEFFLER GROUP
Minimum Buy Quantity	N/A
Weight / Kilogram	0.407
Product Group	M06110
Number of Mounting Holes	3
Mounting Method	Set Screw
Housing Style	3 Bolt Round Flange Block
Rolling Element	Ball Bearing
Housing Material	Stamped Steel
Expansion / Non-expansion	Non-expansion
Mounting Bolts	8.7 Millimeter
Relubricatable	Yes
Insert Part Number	GYE20KRRBVA



BEARING Driveshaft do Brasil

Seals	Double Land Riding Rubber Contact
Housing Configuration	1 Piece Solid
Pilot Configuration	No Pilot
Inch - Metric	Metric
Long Description	3 Bolt Round Flange Block; 20MM Bore; 71MM Bolt Circle; 61MM Bolt Spacing; 1 Piece Solid; Set Screw Mount; Stamped Steel; Ball Bearing; 31MM Length Thru Bore; Relubricatable; Double Land Riding Rubber
Other Features	Single Row Corrosion Resistant With Grub Screw
Category	Flange Block
UNSPSC	31171501
Harmonized Tariff Code	8483.20.40.40
Noun	Bearing
Keyword String	Flanged
Manufacturer URL	http://www.ina.com
Manufacturer Item Number	GRRY20VA
Weight / LBS	0.75
Bore	0.787 Inch 20 Millimeter
Length Thru Bore	1.22 Inch 31 Millimeter
Bolt Spacing	2.4 Inch 61 Millimeter
Cartridge Pilot Diameter	0 Inch 0 Millimeter
Nominal Bolt Circle Diameter Round	2.8 Inch 71 Millimeter
Cartridge Pilot Depth	0 Inch 0 Millimeter